

What interface does the LX optical module use





What interface does the LX optical module use

Understanding 1000BASE-LX SFP for Modern Networks



Enter the 1000BASE-LX SFP (Small Form-factor Pluggable) transceiver - the workhorse for long-distance fiber optic connections. This

GLC-LH-SMD Cisco 1000BASE-LX/LH SFP Module - Specs

Cisco GLC-LH-SMD is a 1Gbps 1000BASE-LX/LH SFP module supporting single-mode fiber up to 10km at 1310nm with DOM diagnostics.



Models, specifications, and compatibility

Models, specifications, and compatibility Gigabit SFP optical transceiver modules use LC connectors. The specifications for Revision D transceiver products are the same as the specified Revision A, B,



1000BASE-SX vs. 1000BASE-LX, Which SFP Module

1000base LX vs 1000base SX SFP Transceiver Module, What's the Difference? The following table clearly shows the main differences between



What is the Difference Between LX and LH SFP Modules?

Since they both operate at the same 1310nm wavelength and use the same transmission protocol, you can connect a 1000BASE-LX module on one

Cisco SFP Modules for Gigabit Ethernet Applications

The 1000BASE-LX/LH SFP, compatible with the IEEE 802.3z 1000BASE-LX standard, operates on standard single-mode fiber-optic link spans of up to 10 km and up to 550 m on any multimode fibers.



190X95X25mm



SX SFP Module Guide: SX vs LX vs SR Differences Explained

While older GBIC modules used SC connectors, modern 1G SFP hardware has standardized on the Small Form Factor (SFF) LC interface to maximize switch port density.



LX SFP Module Guide: What Is 1000BASE-LX and vs LR LH SX

1000BASE-LX is a Gigabit Ethernet optical standard defined under IEEE 802.3, designed for long-wavelength transmission over fiber. The "LX" stands for Long wavelength, typically operating



1000BASE-LX SFP: A Complete Guide for Gigabit Fiber Networks

1000BASE-LX SFP is a Gigabit Ethernet optical transceiver designed for long-distance fiber links, typically up to 10km over single-mode fiber. It operates at a 1310nm wavelength and is widely used in



LX SFP Module Guide: What Is 1000BASE-LX and vs LR LH SX

? What Is 1000BASE-LX? Before comparing LX with other SFP types such as LR, LH, or SX, it is important to first understand what 1000BASE-LX actually represents in terms of standards,



1000BASE-SX, 1000BASE-LX, 1000BASE-ZX& BX SFP:

Like 1000BASE-LX, it uses the same long wavelength of 1310nm but provides a higher power budget to achieve more considerable distances.

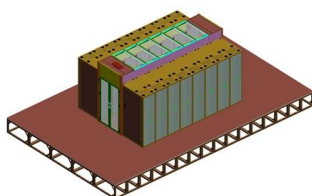

Gigabit Ethernet



Optical fiber transceivers are most often implemented as user-swappable modules in SFP form or GBIC on older devices. IEEE 802.3ab, which defines the widely used



1000BASE-LX: Complete Technical and Deployment Guide

When used with multimode fiber, mode-conditioning patch cables are typically employed to minimize differential mode delay (DMD), ensuring clean signal transmission and stable link performance.

What is the difference between LH and LX modules?

I would like to know the difference between LX and LH SFP modules. Long Haul (LH) denotes longer distances while Long Wavelength (LX) denotes less energy which is obviously



1000BASE-LX vs 1000BASE-SX SFP Transceivers Key

Selecting the wrong optical module can lead to compatibility headaches, unnecessary expenses, or failed links. This guide dives deep into the



1000BASE-LX optical Ethernet/SAN specification

The 1000BASE-LX PTMs can be used for GbE, 1Gbps and 2 Gbps Fibre-Channel, and FICON service over Single-Mode Fiber (SMF). The following are the 1000BASE-LX system specifications: The PTM



What is the Difference Between LX and LH SFP Modules?

Confused by LX vs. LH SFP modules? We explain the difference between IEEE 1000BASE-LX and Vendor 1000BASE-LH, and what it means for

Optical Modules for Huawei S Series Switches

A switch must use optical or copper modules that have been certified for use on Huawei switches. Non-certified optical or copper modules cannot ensure transmission reliability and may affect service



Essential Guide to 1000BASE-LX SFP Transceivers

Q: What kind of connector does the 1000BASE-LX SFP transceiver use? A: This device normally uses an LC connector, which guarantees reliability



How to Choose LX or SX SFP Module

Understand SFP Module An SFP (Small Form-factor Pluggable) module is a compact, hot-swappable device used in networking equipment for data

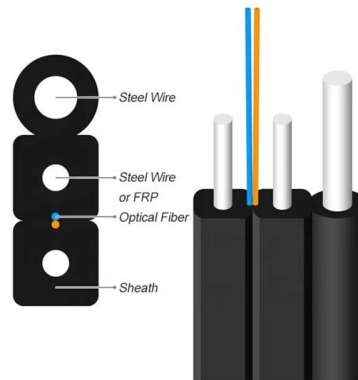

SFP Optical Transceiver Modules for Long Distance: A

Discover everything you need to know about SFP optical transceiver modules for long-distance fiber transmission. Compare LX, EX, ZX models and

The Differences of 1G Optical Modules: LX vs SX

Uncover the key differences between 1G LX and SX modules, aiding you in making the right choice for your network needs. Embrace the power of 1G



SFP1G-LX-31 10km

The SFP1G-LX-31 series single-mode transceivers are small form factor pluggable module for bi-directional serial optical data communications such as Gigabit Ethernet 1000BASE-LX and Fiber



A Comprehensive Guide to Understanding 1G Optical

Explore the key differences between 1000BASE-LX and 1000BASE-SX modules, and grasp the vital role they play in enabling efficient and reliable



PRODUCT CATEGORY				
Open rack Series	Open Heavy rack	12U Apert open rack	18" Deepen Wall rack	Adjustable Depth Open rack
Wall mount rack Series	Glass door Wall mount rack	Mesh door Wall mount rack	Double section Wall mount rack	Economic type Wall mount rack
Floor standing server rack	Glass door with casters	Mesh door with casters	42U Standard Server rack	Double open door Server rack
Outdoor cabinet	air conditioner Outdoor cabinet	Outdoor cabinet with plinth	Outdoor cabinet with fan cooling	Double Wall Outdoor cabinet
Splitter series	Bare Fiber Splitters	Blackless Fiber Splitters	ABS Splitter	Fanout Splitters
Splitter series	LX Splitters	Rack Mount Splitters	Mix Plug-in Type Splitter	Tray Splitters
Patch cord series	LC	SC	FC	LC
FTTH product series				

What is the difference between LX and LR SFP?

LX modules are commonly used for longer-distance connections, typically over multimode or single-mode fiber. For 1000BASE-LX (Gigabit Ethernet), the LX module supports a range of up to

Contact Us

For datasheets, pricing, or custom high-speed optical interconnect solutions, please visit:
<https://www.syropy.com.pl>