

Replacing batteries in Huawei smart power distribution cabinets

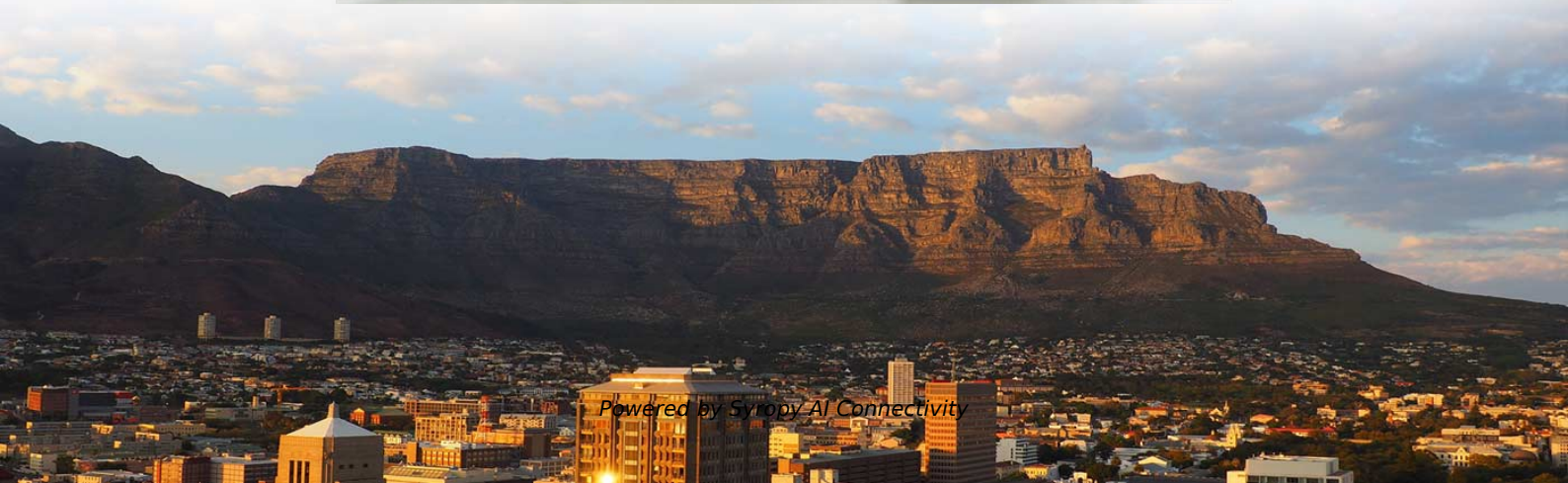



Overview

When installing batteries, install battery trays at first, then place batteries onto the trays, and connect cables. Only qualified personnel can replace the components for power supply and distribution system. Purpose This document describes routine maintenance, troubleshooting, and parts replacement of the LUNA2000-200KWH-2H1 Smart String Energy Storage Systems (ESS). Huawei energy storage battery cabinets have become a game-changer in power management, offering scalable energy storage solutions for industries ranging from renewable energy projects to emergency backup systems.



Replacing batteries in Huawei smart power distribution cabinets

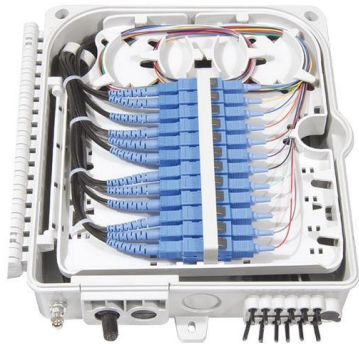

PDU8000 UPS Power Distribution Cabinet User Manual

O& M personnel must be qualified power distribution system engineers who are familiar with the data center power supply and distribution system configurations and the operations for

Replacing a Power Distribution Unit

Tools: step ladder, Phillips insulated torque screwdriver
Material: new power distribution unit of the same model
Before the replacement, ensure that the load services are not affected or obtain written



SmartLi Lithium UPS System , UPS Lithium Battery

Huawei SmartLi is a lithium UPS solution using smart lithium-ion batteries to deliver safe, efficient, and scalable backup power for data centers and critical facilities.

Installing Power Supply and Distribution Devices

Installing Power Supply and Distribution Devices
Installing a PDU2000M (Optional)
Installing UPSs Outside the Smart Module (Optional)
Installing Battery Cabinets Outside the Smart Module



SmartLi 2.0 User Manual

Purpose This document describes the SmartLi 2.0 intelligent lithium battery cabinet (lithium battery cabinet for short) in terms of its overview, transportation, storage, installation, cable connection,



PDU8000 Modular Precision Power Distribution Cabinet User Manual

Before installing or removing a power cable, turn off the power switch. Before connecting a power cable, verify that the label on the power cable is correct.

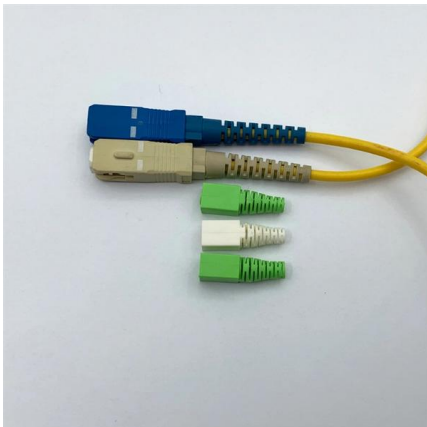

HUAWEI PDU8000 USER MANUAL Pdf Download

View and Download Huawei PDU8000 user manual online. Modular Precision Power Distribution Cabinet. PDU8000 power distribution unit pdf manual download.



Installing Power Supply and Distribution Devices

The battery pack needs to be installed in the IT cabinet to the right of the Converged Cabinet. If no smart cooling product is installed in the IT cabinet, install battery packs from bottom to top with an interval



Battery Cabinet

Lead-Acid Battery Cabinet A maximum of three battery groups in up to six battery cabinets can be deployed inside the smart module. If many batteries are configured, they can be deployed outside

Installing Power Supply and Distribution Devices

Installing Power Supply and Distribution Devices (Optional) Installing UPSs Outside the Smart Module (Optional) Installing Battery Cabinets Outside the Smart Module (Optional) Installing Lead-Acid



Replacing Power Supply and Distribution System Components

Remove the battery wiring terminals between the batteries and the faulty UPS. Open the front door of the cabinet, remove the protective panel from the maintenance bypass switch, and manually turn on



PDU8000 Modular Precision Power Distribution Cabinet Quick Guide

power distribution 2 quantity o The cable steady on. If no, replace Critical monitoring boards is inconsistenc has the monitoring board. different from the y become o Check whether the



Replacing Power Supply and Distribution System Components

Only qualified personnel can replace components of the power supply and distribution system. Wear protective tools such as insulation gloves and shoes before replacing a power supply and distribution

How to Use Huawei Energy Storage Battery Cabinet: A Step-by-Step

From solar farms to hospital backup systems, Huawei's energy storage cabinets are like the Swiss Army knives of power management. Whether you're looking to cut energy costs or boost renewable



Huawei Rectifier Cabinet Setup Guide

This document provides instructions for installing and configuring a Huawei rectifier cabinet. It discusses positioning tenant load circuit breakers, installing lithium



Power Supply and Distribution Cabinet Scenario

C:01520092,02232DSL;M:FusionModule2000C,FusionModule2000 6.0 Documentation Data Center Facility Smart Modular DC FusionModule2000 6.0 Installation & Upgrade Transportation and



Replacing the MCB or Input MCB

Disconnect cables from the faulty input MCB. Connect the cables to the new input MCB based on the cable labels. Install the new input MCB, as shown in Figure 8-4.

SmartLi Cabinet Description

SmartLi 2.0 is a self-developed battery energy storage system solution. It provides a cabinet-level battery management system and supports a maximum of 15 cabinets connected in parallel to meet



Installing Power Supply and Distribution Devices

Install batteries and connect cables from bottom to top. When installing batteries, install battery trays at first, then place batteries onto the trays, and connect cables. Do not move all the batteries into the



Maintenance Manual

Before transporting, storing, installing, operating, using, and/or maintaining the equipment, read this document, strictly follow the instructions provided herein, and follow all the safety instructions on the



How to remove batteries from Huawei energy storage cabinets

This system is designed for residential use, combining energy storage batteries, solar panels, and smart control technology. It ensures maximum energy efficiency by optimizing solar power generation,

Huawei Rectifier Cabinet Setup Guide

It discusses positioning tenant load circuit breakers, installing lithium battery power and communication cables, modifying battery communication cables, and the



Power Supply and Distribution System



Power Supply and Distribution System

It uses the battery cabinet tray of the smart module 3.0 and is compatible with 26 Ah, 40 Ah, 65 Ah, 80 Ah, and 100 Ah batteries. The battery input switch and intelligent battery monitoring



Power Supply and Distribution System

C:21268608,21268610,21268803;M:FusionPower 9000 System Composition The power supply and distribution system of the FusionPower9000 consists of the low-voltage input cabinet, general

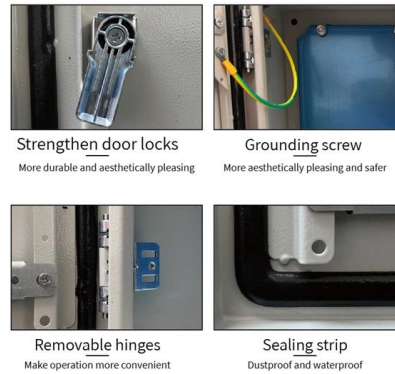

PDU8000 Modular Precision Power Distribution Cabinet User Manual

The user manual for the PDU8000 Modular Precision Power Distribution Cabinet provides detailed instructions for installation, operation, and maintenance.

Replacing Components for the Power Supply and Distribution System

Power off the upper-level equipment before replacing a power supply and distribution component. Use a multimeter and electroprobe to check whether the front and rear ends of the component to be



HUAWEI LUNA2000-200KWH-2H1 MAINTENANCE MANUAL Pdf

Purpose This document describes routine maintenance, troubleshooting, and parts replacement of the LUNA2000-200KWH-2H1 Smart String Energy Storage Systems (ESS). Before maintaining the ESS,



Replacing Power Supply and Distribution



System Components

Only qualified personnel can replace components of the power supply and distribution system. Wear protective tools such as insulation gloves and shoes before replacing a power supply and distribution



Contact Us

For datasheets, pricing, or custom high-speed optical interconnect solutions, please visit:

<https://www.syropy.com.pl>