

H3 Gigabit Aggregation Switch

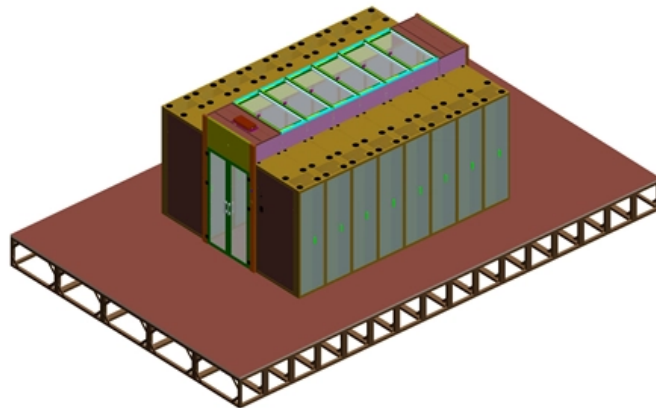



Overview

H3C S5590-EI series switches support the 1588V2 function to meet the high-precision time synchronization requirements between network devices. As the network scale increases, many access devices are required at the network edge, which makes the management of these devices very cumbersome. H3C S5590-EI series switches implement a hardware-based IPv4/IPv6 dual-stack platform, support multiple tunnel technologies, rich IPv4 and IPv6 Layer 3 routing protocols, multicast technologies and policy routing mechanisms, providing users with complete IPv4/IPv6 solution.



H3 Gigabit Aggregation Switch



H3C Products Catalogue

H3C S5570S-EI products are mainly positioned at the access layer and aggregation layer of enterprises and campuses, meeting high-density Gigabit access, fixed 10 Gigabit uplink ports, supporting PoE+,

Switch Aggregation

An 8-port, Layer 2 switch made for 10G SFP+ connections.



Aggregation Switch , D-Link

Aggregation Managed Switches Streamlined Aggregation, Maximum Efficiency Versatile Speeds Provides 1G, 2.5G, and 10G speeds for flexible customization,

H3C S6530X Series Advanced Aggregation 10GE Switches Datasheet

H3C S6530X series switches support Telemetry technology, which can send the switch's real-time resource information and alarm information to the O& M platform through the gRPC protocol.



Switches-H3C

H3C industrial switches can operate in -40°C - 75°C environments for a long time, and use industrial components to reach IP40 rating. At the same time, with

H3C S5120-SI Series Gigabit Ethernet Switches

OVERVIEW H3C® S5120-SI Series Gigabit Ethernet Switches are intelligent, manageable Layer 2 switches that provide high performance, high-density port access and simplified installation to



H3C S6520X-HI Series Advanced Aggregation 10GE

H3C S6520X-HI series switches -- Industry-leading high performance and scalable 10GE access switching solution developed by H3C using ASIC technology with



H3C S6530X Series Advanced Aggregation 10GE Switches

H3C S6530X series switches provide industry-leading high performance and scalable aggregation switching solution with modular dual power, fixed uplinks (40GE/100GE) and IRF for resiliency.

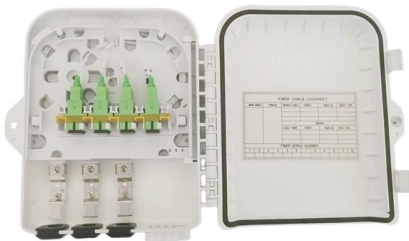

H3C S5580X-HI Series Switches

It is a Gigabit Layer 3 Ethernet switch product for converged service networks.

Aggregation Switch 24-Port HSP-IO-24GE4XS-C2AH

Aggregation Switch 24-Port HSP-IO-24GE4XS-C2AH Overview: Fully Managed L2 and L3 Lite Stackable Switches All Gigabit Ethernet Access Ports with 10G Uplinks in a fixed 1U configuration

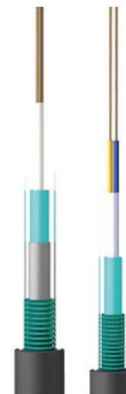

Campus Switches

Campus Switches Huawei S Series Switches fully accommodate metro core, aggregation, edge aggregation, and access networking requirements, and are



H3C S5590-EI Series Converged Gigabit Switches-H3C

SmartmcMulti-Service IntegrationHigh-Performance IPv4/IPv6 Service CapabilityIRF2Complete Security Control StrategyMACsec Hardware EncryptionPrecision Time ProtocolIntelligent Network Quality AnalyzerMultichassis Link Aggregation GroupVisualization AbilityH3C S5590-EI series switches support the 1588V2 function to meet the high-precision time synchronization requirements between network devices. Compared with GPS time synchronization with the same precision, it improves security and lowers deployment costs.See more on h3c H3C



H3C S5580X-HI Series Switches

It is a Gigabit Layer 3 Ethernet switch product for converged service networks.



Stackable Aggregation Managed Switches

Stackable Aggregation Managed Switches Streamlined Aggregation, Maximum Efficiency Versatile Speeds Provides 1G, 2.5G, and 10G speeds for flexible

H3C S6520X-30HC-HI Series Advanced 10GE Aggregation Switches

H3C's S6520X-HI Series switches offer industry-leading performance and scalability among 10GE access switches, with support for dual replaceable power supplies, fixed or modular backbone



Aggregation Switches , Managed Core Network



High-performance aggregation switches designed for industrial and FTTH networks. Support Layer 2/3 management, Gigabit and 10G uplinks, redundant power,



Aggregation Network Switches , Grandstream Networks

Layer 3 aggregation switches that allow enterprises to build scalable, secure, high performance and smart business networks that are fully manageable and support



H3C S6526XE-HI Series Advanced Aggregation 10GE Switches

H3C S6526XE-HI series switches Industry-leading high performance and scalable 10GE access switching solution with modular dual power, fixed or modular uplinks (10GE/40GE/100GE) and IRF

The leader in digital and AI solutions-H3C-H3C

H3C is committed to becoming the most trusted partner of its customers in their quest for business innovation and digital transformation. We offer a full portfolio of





Switch Hi-Capacity Aggregation

A 32-port, Layer 3 switch made for high-capacity 10G SFP+ and 25G SFP28 connections.



H3C S5580X-HI Series Switches

In the campus network, H3C S5580X-HI series switches can be used as aggregation layer equipment, or as the core of small and medium-sized enterprises; downward can provide high-density GE



H3 C S5580S-48T6X-EI 48 Port Advanced Aggregation Gigabit Layer

It is a gigabit Layer 3 Ethernet switch product for converged service networks. In campus networks and data center networks, the H3 C S5580X-EI and S5580S-EI series switches can be used as

H3C S6526XE-EI Series Advanced Aggregation 10GE Switches

H3C S6526XE-EI series switches Industry-leading high performance and scalable 10GE access switching solution with modular dual power, fixed or modular uplinks (10GE/25GE/40GE/100GE) and





H3C S6530X Series Advanced Aggregation 25GE

H3C S6530X series switches provide industry-leading high performance and scalable aggregation switching solution developed by H3C using ASIC



H3C S5120V3-LI Layer 3 Gigabit Access Switch Series

H3C S5120V3-LI Ethernet switch series supports Internet broadband access and offers Gigabit port access and uplink interface for small and medium-sized enterprises.



H3C S5590-EI Series Converged Hybrid Multigiga Switches-H3C

Multichassis Link Aggregation Group (M-LAG) (Original DRNI) H3C S5590-EI series switches support M-LAG, which enables links of multiple switches to aggregate into one to implement device-level link

Products & Technology

Switches After over 20 years of networking innovation, research and development, H3C has accumulated significant industry-leading Ethernet-related intellectual





S5320 Gigabit Ethernet Switches -- Huawei products

S5320 Gigabit Ethernet Switches The S5320 series gigabit Ethernet switches are energy-saving switches developed by Huawei to meet the demand for high

Contact Us

For datasheets, pricing, or custom high-speed optical interconnect solutions, please visit:
<https://www.syropy.com.pl>