

Fibre Channel SAN Storage

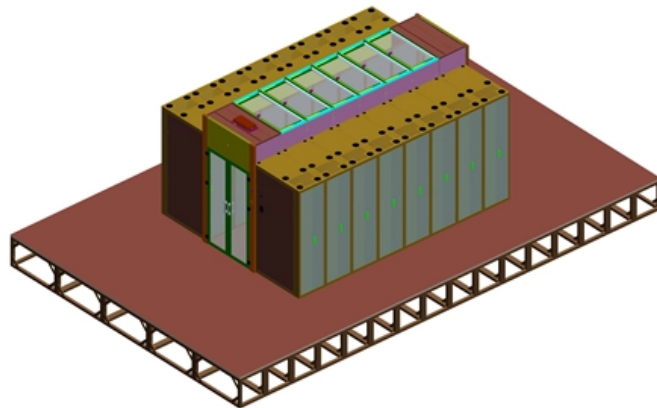



Fibre Channel SAN Storage



Fiber Channel disaggregated pattern without backup network

This article describes the network reference pattern for disaggregated Azure Local clusters that use Fiber Channel (FC) Storage Area Network (SAN) external storage without a

4.4 Introduction to Fibre Channel (FC) SAN Architecture

The FC SAN physical components such as network cables network adapters and hubs or switches can be used to design a Fibre channel Storage Area

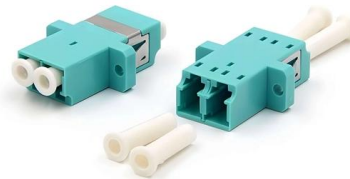

What is Fibre Channel SAN and How Does It Work?

Fibre Channel SAN, which stands for Fibre Channel Storage Area Network, is a high-speed network technology that enables the connectivity and

Everything you need to know about Fibre Channel Storage

Fibre channel storage has become the de facto standard for high-performance storage for connecting block storage using a fibre channel storage network as a



Reliable, scalable and affordable FC SAN storage

By using a QNAP NAS with Fibre Channel connectivity, your NAS can be easily added to your existing SAN environment at an affordable price point. This allows



Fibre Channel SAN Concepts

To transfer traffic from host servers to shared storage, the SAN uses the Fibre Channel (FC) protocol that packages SCSI commands into Fibre Channel frames. To restrict server access to storage

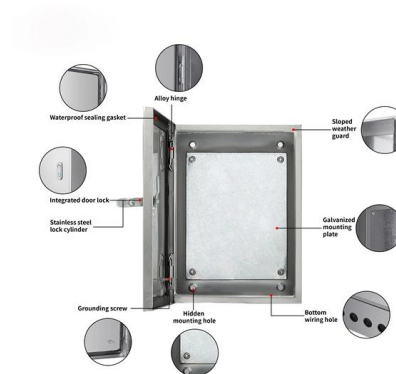

What is a Fibre Channel switch? , Definition from

A Fibre Channel (FC) switch is a networking device that's compatible with the FC protocol and designed for use in a dedicated storage area network



What is SAN Storage? - Storage Area



Networks , Glossary

Storage area networks can span multiple sites and are often based on fibre channel (FC) technology. They use either fibre channel protocol (FCP) or proprietary variants depending on what kind of



Dell 7W801 Fibre Channel Host Bus Adapter for Enterprise Storage

Upgrade your storage network performance with the Dell 7W801 1-Port Fibre Channel Host Bus Adapter. ?? Designed for enterprise server environments, this adapter delivers reliable 2Gb/s



Marvell Technology, Inc. , Essential technology, done right

Designed for your current needs and future ambitions, Marvell delivers the data infrastructure technology transforming tomorrow's enterprise,



Fibre Channel over Ethernet

Fibre Channel over Ethernet (FCoE) is a computer network technology that encapsulates Fibre Channel frames over Ethernet networks. This allows Fibre Channel to use 10 Gigabit Ethernet networks (or





Efficient SAN Fibre Channel Data Storage , Open-E

Experience seamless, high-speed data storage with Fibre Channel (FC). Our brochure explores how FC technology enhances SAN enterprise storage,



StarWind SAN et NAS per Fibre Channel

Integratio Fibre Channel non est facilis negotium, quam ob rem pleraeque solutiones SDS in Ethernet fundantur. Nihilominus, multae societates utilitates firmitatis et latentiae quas

4.4 Introduction to Fibre Channel (FC) SAN Architecture

Several configuration definitions in an FC SAN use WWN for identifying storage systems and FC HBAs. WWNs are critical for FC SAN configuration as each

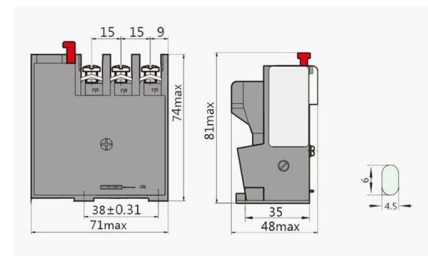

What is SAN (Storage Area Network)? , The Role of SAN!

SAN (Storage Area Network) is a unique network that connects servers, disk arrays, and media libraries. It uses fiber channel technology and



Fibre Channel storage area networks

A Fibre Channel storage area network (SAN) is a specialized, high-speed network that attaches servers and storage devices. With a SAN, you can create an any-to-any connection across the network with



P79250-B25

P79250-B25 - Hpe Msa 1060 San Storage System
- 24 X Hdd Supported - 12 X Hdd Installed - 14.40
Tb Installed Hdd Capacity - 12gb/s Sas - 24 X Ssd
Supported - Clustering Supported - 2 X 16gb/s
Fibre

Broadcom LPE35002-M2 32GFC 2-Port PCIe Adapter , SAN, Enterprise

Accelerate Fibre Channel storage access with 32GFC, 2 ports, and PCIe connectivity. Built for dense SAN fabrics and dependable enterprise throughput.



Storage Area Network, Fibre Channel, SAN und FC

Ein Storage Area Network verbindet Server und Speichersysteme in einem Unternehmen mit einem hochperformanten und hochredundanten Netzwerk auf



Search Storage Information, News and Tips from TechTarget

How telemetry can transform storage strategies
Storage telemetry data gives IT leaders the insight needed to bridge visibility gaps in on-premises, hybrid and multi-cloud environments.



linux

I have a serious problem with a SAN storage array connected to a Linux box through Fibre Channel. Here is the configuration : Debian with plain vanilla linux 2.6.27.25 Fibre controller QLogic 4Gb d

Broadcom's Latest SAN Switch Offers Scalable, Energy-Efficient

Brocade Gen 7 Fibre Channel combines cyber-resilient and autonomous SAN technology into this cost-effective platform that seamlessly integrates into rack-based storage solutions, the



CONNECTRIX B-SERIES DS-6600B SWITCHES

With its speed and port density the DS-6620B can be deployed in any Fibre Channel Storage Area Network (SAN) to enable very dense fabrics in a relatively small package.



Fibre Channel Module Selection Guide for SAN Network

Learn how to choose the right Fibre Channel modules for enterprise SAN upgrades. This guide covers 8G, 16G, 32G, and 64G modules, highlighting



LED DISPLAY PANEL

CURRENT STATUS CLEARLY VISIBLE

IT CAN CLEARLY SHOW THE CURRENT STATUS AND VOLTAGE STATUS, WITH EFFICIENT OPERATION AND RAPID RESPONSE.

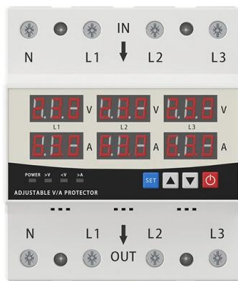

Fiber Channel SFP: A Complete Guide for Storage Networks

A Fiber Channel SFP is a specialized optical transceiver designed exclusively for Fiber Channel (FC) networks, enabling high-speed, low-latency, and lossless data transmission in Storage Area Network

Fibre Channel vs. iSCSI: What are the differences?

Today, these two SAN technologies are rarely positioned as competitors. Major server and storage vendors don't necessarily see it as Fibre Channel vs. iSCSI; most popular SAN arrays



Broadcom LPE35000-M2 32 Gb Fibre Channel PCIe HBA , Enterprise SAN

Keep storage paths fast with 32 Gb Fibre Channel, PCIe connectivity, and single-port design--ideal for enterprise SAN hosts and dense workloads.



Storage Area Networks (SAN) Solutions , IBM

Storage area network (SAN) solutions Achieve high availability, scalability and proven data security NVMe Over Fibre Channel,



Support Documents and Downloads

Search technical documentation and downloads including firmware and drivers.



Contact Us

For datasheets, pricing, or custom high-speed optical interconnect solutions, please visit:
<https://www.syropy.com.pl>