

# **Anping Busbar Cable Tray**





## Anping Busbar Cable Tray

---



### Busway and Cable Tray Installation

It involves calculating angles and bends as well as measuring and cutting cable trays prior to overhead installation. Because this task requires work at elevation, ladders or other types of lift equipment are

### Perforated Metal Cable Tray - Anping Harmony Metal

It is used in almost every industry for supporting power cables, electrical cables, network cables, data communication cables, and power distribution. Available in



### Cable Bus , Cable support , Busway

It offers an ideal hybrid solution between cable tray and busway, delivering superior cable support and isolation for high-power transmission and a highly

### 100mm heavy duty cable tray carrying multiple rows hv cables

100mm heavy duty cable tray carrying multiple rows hv cables or dense busbars Ecer - China  
Factories 19.2K subscribers [Subscribe](#)



### Installing a Smart Busbar, Cable Trough, and Cable Tray

Installing a Smart Busbar, Cable Trough, and Cable Tray Translation Favorite Download



### White Paper #2402 Comparing Cable Tray and Cable Bus for Power

Introduction Power distribution systems play a critical role in transmitting electrical energy from a source to various loads. Cable tray (NEC Article 392) and cable bus (NEC Article 370) are two commonly

**REINFORCED VIRGIN PVC TRUNKING**  
Superior Crush Resistance

	<b>37.6MPA</b> Tensile Strength		<b>2856MPA</b> Elastic Modulus
	<b>9.8KJ/M<sup>2</sup></b> Impact Strength		<b>1.54G/CM</b> Density

### DATA RACK BUSBAR

Whisker free and tin plated solid form conductors ensure for better heat dissipation, higher short circuit values and longer operation life while significantly contributing to the "Availability" challenge in the





## Cable Tray, Cable Bus, Wire Mesh Cable Trays , MP

No other cable tray or cable bus manufacturer can match the experience, engineering proficiency or manufacturing capabilities of MP Husky. Our team of



## 1,000+ Huijue Busbar Cable Tray Prices jobs in United States

Today's top 1,000+ Huijue Busbar Cable Tray Prices jobs in United States. Leverage your professional network, and get hired. New Huijue Busbar Cable Tray Prices jobs added daily.

## Busbar vs Cable Tray: Power Distribution Explained

Discover key differences between busbars and cable trays in electrical systems. Fuspan offers IEC-certified, export-ready busbar solutions for industrial use.

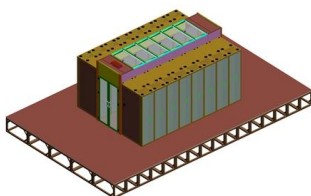

## Busbar Systems & Electrical Trunking , Schneider

Design a flexible and efficient power distribution system with Schneider Electric UK's innovative busbar systems. Explore Canalis busbars for a modular approach to



## Lighting Busbar

KY-S Busbars with an approx. 4 times faster assembly time compared to the cable tray; o Boltless, easy-to-install fixing structure, o Fast energy supply with output plugs, o Its modular



## Bus Bar, Bus Ducts, Cable tray

Electrical busbar systems (sometimes simply referred to as busbar systems) are a modular approach to electrical wiring, where instead of a standard cable wiring to every single electrical device, the

## Support Systems for Cable Trays & Busbars

Reliable support systems for cable tray and busbars, designed for electrical and mechanical installations. Available in corrosion-resistant coatings.

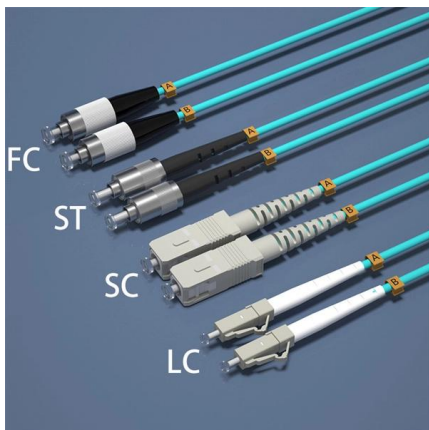

## Knowledge

ACE ELECTRIC is one of the most professional Busbar manufacturers and suppliers in China, featured by quality products and good service. Please rest assured to wholesale customized Busbar made in



## China Cable Tray Manufacturers, Bus Duct Suppliers,

The XQJ series cable trays produced by our company are divided into eight series: steel and stainless steel ladder type, tray type, groove type, combination type,



Product Parameter	
Product Type	Cable tray, ladder, perforated and wire mesh cable tray
Material	60 series 304L, 304, 201, 201AL, Aluminum, 30304/316/316F
Finish	10. Electro-galvanized, Powder coated, Electrolytic, polished
Width	50-1500mm
Height	25mm, 30mm, 35mm, 100mm, 150mm or as you required
Thickness	0.8-2.0mm (Diameter down down for wire mesh cable tray)
Length	2m, 3m, 4m, 5m, 6m, 8m
Surface	0.025-0.040 or Customized
Lead Time	10 days for a 20 container, 14 days for a 40 container
Port of Loading	Shanghai Port, Ningbo Port etc.

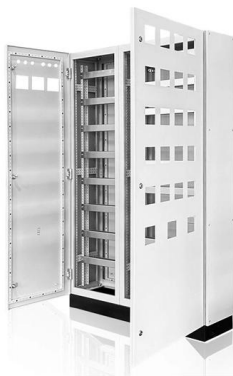

## Busway and Cable Tray Installation

Cable Tray Installation is the process of installing a structural system to securely fasten and support cables and raceways. It involves calculating angles and bends as well as measuring and cutting

## China Cable Tray Manufacturers, Bus Duct Suppliers,

Zhenjiang Ace Electric Group Co., Ltd: We produce best quality of cable tray including ladder cable tray, channel cable tray, wire mesh cable tray, perforated



## Four very important precautions for the installation of

Energy transport via cables and busbars First, to be clear, there are dozen of concerns and precautions you should be aware of when we talk about



## Tunnel and Rail System Solutions , EAE Electric

Tunnel and Rail System Solutions For energy distribution and cable management in tunnelling and rail systems, EAE offers long-lasting, reliable and efficient



### Flexible Busbars

Cable trays are systems used for the safe transportation and protection of electrical cables, designed to fit the pathways within buildings and structural installations.

### What's the Difference Between Busbars and Cables?

Busbars and cables have unique advantages and disadvantages. This article delves into the mysteries and technology of busbars.



### Buy Cable Tray,wire Mesh,wanwei from Anping County Jixing

Buy low price Cable Tray,wire Mesh,wanwei by Anping County Jixing Hardware And Mesh Products Co., Ltd., a leading supplier from China. 745 similar products are also available from global exporters.



### **BIM objects , Revit families , EAE Electric**

BIM objects. Download Free Revit families from EAE Electric. Revit Library for Busbar trunking, cable tray & Fit-Out Solutions!



### **Support Systems General Information**

E-Line A-A (support Systems) are designed for use in buildings and factories, whether made of reinforced concrete or steel, to support systems such as

## **Contact Us**

---

For datasheets, pricing, or custom high-speed optical interconnect solutions, please visit:  
<https://www.syropy.com.pl>