

35kV Busbar Section Switch

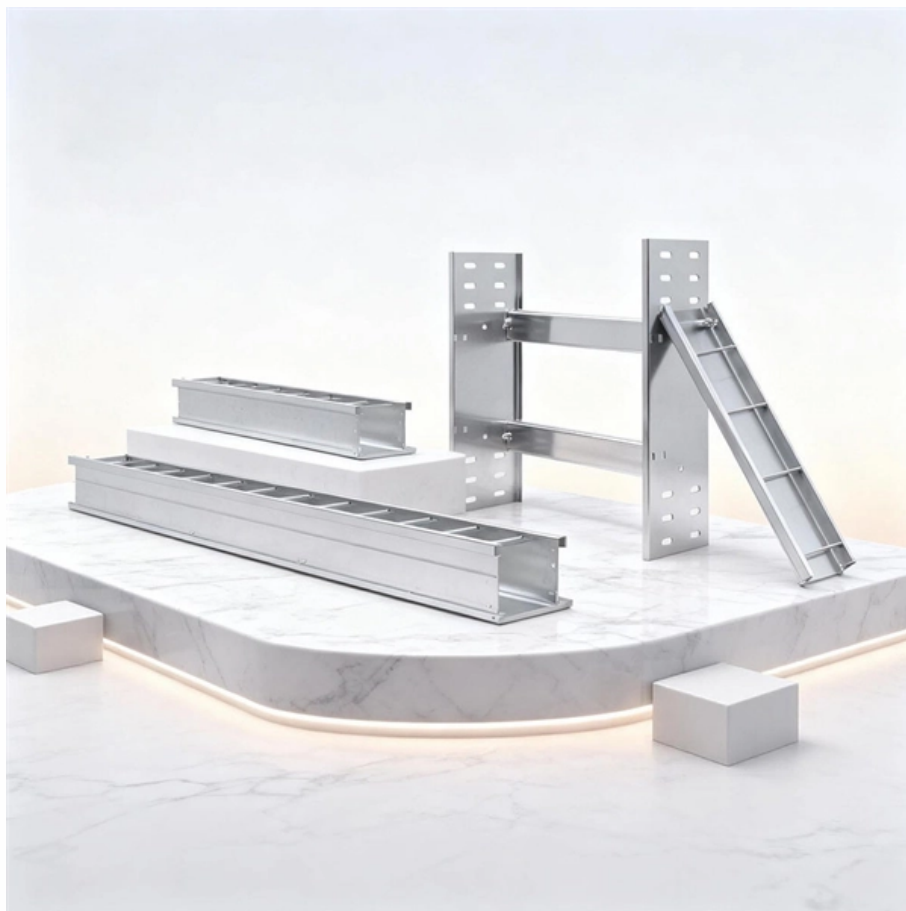



35kV Busbar Section Switch



Functional Specification for 15 kV, 25 kV, or 35 kV Underground

The visible break option will consist of an isolating switch, in series with the vacuum switch, which meets all of the continuous current and voltage ratings of the switchgear.

ZX2 , ABB

A compact and modular medium voltage switchgear with high technical parameters and ratings built as a three-phase encapsulated and arc-resistant design for single and double busbar applications. ZX2 is

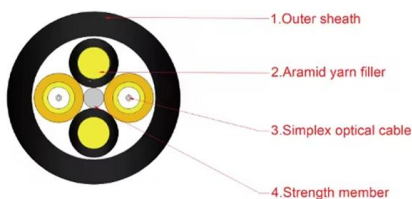

SPECIFICATION NO

1.00Scope: 1.1. This specification covers design, manufacture, assembly, testing before supply, inspection, packing and delivery of metal clad partitioned, SF6 gas insulated switchgear confirming to

MEDIUM VOLTAGE SWITCHGEAR

Earthing switch is used to connect the cables or busbar to the earth for safety during maintenance and other works to be executed on the switchgear. It has a fast acting mechanism independent to the



Gas-insulated medium voltage switchgear

In gas-insulated switchgear, earthing of switchgear sections is performed by a high quality vacuum circuit-breaker. The circuit-breaker can close onto a short-circuit significantly more frequently and



PowlVac® Switchgear

PowlVac switchgear combines high-quality circuit breakers and medium-voltage switchgear for reliable industrial electrical performance.



Busbar Connection System Top busbar system (35kV) 35kV SU

35kV top busbar connector used in GIS system switchgear busbar connection system, mainly by the T-joint, cross connector, shield bus composition, to achieve the switchgear of the insulated, fully





BUSBAR PROTECTION

Switchgear positional information should be used to determine the primary arrangement of each busbar section using busbar disconnectors and/or circuit breakers, and to determine the selection of end

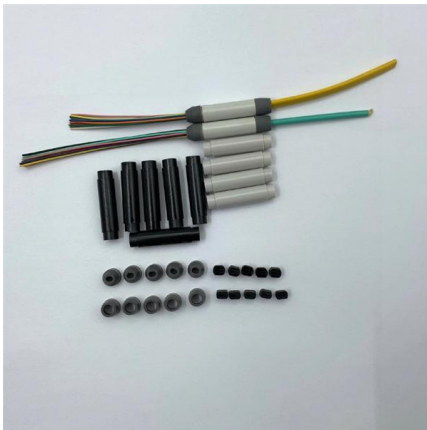

2CDC446001D0201

Busbar systems and installation accessories
When connecting aluminum conductors, ensure that the contact surfaces of the conductors are cleaned, brushed and treated with grease.

Gas-Insulated Switchgear (GIS) for rated voltages of 35kV, up to 4000A

Fixed-mounted circuit-breaker switchgear 8DA and 8DB is indoor, factory-assembled, type-tested, single-pole metal-enclosed, SF6-insulated switchgear for rated voltages of 35 kV with metallic

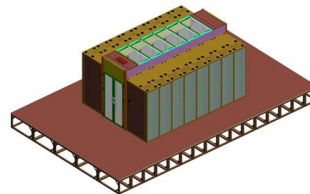

600 A 35 kV class deadbreak apparatus bushing

General Eaton's Cooper Power™ series 600 A, 35 kV class deadbreak apparatus bushing meets the full requirements of IEEE® Std 386TM-2006 for separable insulated connector systems. All 600 A



Technical catalogue TK 501/15 en ZX1.2 Gas-insulated medium

Circuit-breaker and three position disconnector
Vacuum circuit-breaker Disconnect/earthing
switch (three position disconnector) with
functions for busbar connection



Sectionalizing Enclosures Three Phase 15, 25 & 35 kV

Provides a safe and convenient primary cable
terminating, sectionalizing, tapping, and
switching point for underground distribution
systems.

P-BA-000211_mIHVZ_V11

1 Low-voltage compartment 2 SIPROTEC bay
controller (option) 3 Operating mechanism for
three-position disconnector 4 Gas pressure
manometer for switchpanel pole housing 5 Gas
filling



Bus Section Circuit Breaker

A bus section circuit breaker is defined as a
device used to connect or disconnect sections of
a busbar in a substation, which can operate in a
normally open or normally closed position to
manage the flow of



Types of Busbar Arrangements in Grid Stations and

The different types of busbar arrangements used in Grid stations and Substations. The Single, Mesh, Ring and Double Busbar arrangements.



Catalog Extract LV 10 · 10/2022

Our busbar systems for electrical installations offer a particularly easy way of fitting distribution systems with electrotechnical components. The modular design saves space, while quick assembly contacts

8DJH 36 for Secondary Distribution Systems up to 36 kV, Gas

Every switchgear block and every individual panel is option-ally available with busbar extension on the right, on the left, or on both sides. This offers a high flexibility for the creation of switchgear



GIS 8DADB CAT

Fixed-mounted circuit breaker switchgear 8DA and 8DB is indoor, factory-assembled, type-tested, single-pole metal-enclosed, gas-insulated switchgear with metallic partitions 3), for single-busbar and



Busway Medium Voltage

Switchgear termination enclosures connect non-segregated phase bus to medium voltage switchgear, medium voltage motor control centers, and low voltage switchgear, switchboards or motor control



8DJH 36 for Secondary Distribution Systems up to 36 kV, Gas

By the busbar couplings on the medium-voltage side. Tolerances between adjacent panels are compensated by spherical fixed contacts and the movable contact coupling with degrees of freedom

Bus Protection Theory

Busbar Protection Techniques The choice of protection technique used for a specific busbar depends on the protection requirements for speed and security, balanced against the cost of implementing a



Medium-voltage metal-enclosed switches technical data

Eaton load interrupter (Type MVS) metal-enclosed switchgear provides safe, reliable switching and fault protection for medium voltage circuits rated from 2.4 kV through 38 kV. The MVS switch is ideal for



Where to start with the design of 132/33 kV substation

This article shall revolve around the design overview of switchgear and protection systems in a typical 132/33 kV power grid substation.



Section 7 Switchgear and controlgear assemblies

Busbars and their supports are to be designed to withstand the mechanical stresses which may arise during short-circuits. A test report or calculation to verify the short-circuit withstand strength of the

Types 8DA10 and 8DB10 up to 40.5 kV and 8DAB 24 blue GIS up to

Three-position disconnecter as busbar disconnecter and feeder earthing switch Make-proof earthing by means of the vacuum circuit-breaker Compact dimensions due to gas insulation Single-pole metal



Contact Us

For datasheets, pricing, or custom high-speed optical interconnect solutions, please visit:
<https://www.syropy.com.pl>